



Nipper technology | Air nippers – manual and automatic operation

Blades for metal, straight

Blades for metal, straight



Model BJ

Product notes

- > Straight blades with one unbeveled cutting edge using the anvil principle or with carbide tips for extra strength
- > BJ: blades using anvil principle to cut thin wire
- > N20BFB: blades in clipper type shape with carbide tips to cut thicker wire or thin pipes

Technical data

Item no.	Material	Max. cutting thickness [mm]			Weight [g]	Air nippers
		Copper wire	Steel wire	Piano wire		
N20BFB	Sintered alloy	2.6	2	1.2	150	GT-N20 GT-NR20 GT-NS20



Dimensions

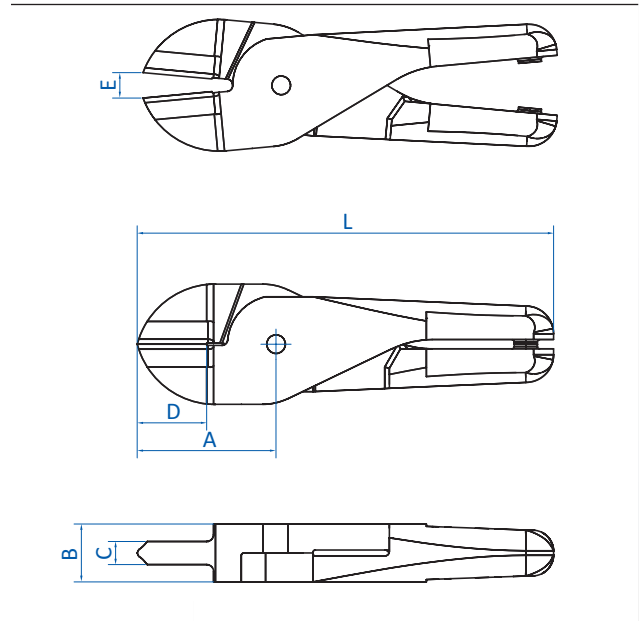

Item no.	A [mm]	B [mm]	C [mm]	D [mm]	E [mm]	L [mm]
N20BFB	35	12	5	17	8	95