

Spring levelers, spring on the inside and threaded connection, Series SZ-NIV-I



Technical Data

Item no.	Lift [mm]	Weight [g]
50.120	7	17
50.123	8	41
50.124	20	73

Dimensions

G1	G2	G3
M5-IG	M5-IG	G1/8-AG
G1/8-IG	G1/8-AG	M14x1,5-AG
G1/8-IG	G1/8-AG	M16x1-AG

Dimensions

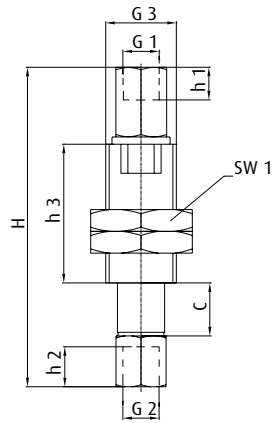

50.120

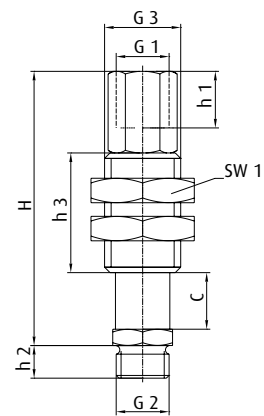

50.123 | 50.124

Spring levelers Standard with threaded connection, Series SZ-NIV-S



Technical Data

Item no.	Lift [mm]	Torsionally rigid	Weight [g]
50.149	10	--	18
50.150	20	--	20
50.152	10	Yes	19
50.153	20	Yes	21
50.158	5	--	17
50.160	25	--	94
50.161	15	Yes	85
50.162	50	--	110
50.164	25	--	136
50.166	75	--	195
50.230	15	--	94
50.231	50	Yes	110
50.232	25	Yes	94
50.233	75	Yes	202

Dimensions

G1	G2	G3
M5-IG	M5-IG	G1/8-AG
M5-IG	M5-IG	G1/8-AG
M5-IG	M5-IG	G1/8-AG
M5-IG	M5-IG	G1/8-AG
M5-IG	M5-IG	G1/8-AG
G1/8-IG	G1/8-AG	M16x1-AG
G1/8-IG	G1/8-AG	M16x1-AG
G1/8-IG	G1/8-AG	M16x1-AG
G1/8-IG	G1/8-AG	M20x1,5-AG
G1/8-IG	G1/8-AG	M20x1,5-AG
G1/8-IG	G1/8-AG	M16x1-AG
G1/8-IG	G1/8-AG	M16x1-AG
G1/8-IG	G1/8-AG	M20x1,5-AG
G1/8-IG	G1/8-AG	M20x1,5-AG

Spring levelers heavy-duty with threaded connection, Series SZ-NIV-HD



Technical Data

Item no.	Lift [mm]	Torsionally rigid	Weight [g]
50.310	15	Yes	83
50.311	25	Yes	89
50.312	50	Yes	104
50.315	15	--	83
50.316	25	--	89
50.317	50	--	104
50.340	25	Yes	134
50.341	50	Yes	160
50.342	75	Yes	786
50.345	25	--	134
50.346	50	--	160
50.347	75	--	186

Dimensions

G1	G2	G3
G1/8-IG	G1/8-AG	M16x1-AG
G1/8-IG	G1/8-AG	M16x1-AG
G1/8-IG	G1/8-AG	M16x1-AG
G1/8-IG	G1/8-AG	M16x1-AG
G1/8-IG	G1/8-AG	M16x1-AG
G1/8-IG	G1/8-AG	M16x1-AG
G1/8-IG	G1/4-AG	M20x1,5-AG
G1/8-IG	G1/4-AG	M20x1,5-AG
G1/8-IG	G1/4-AG	M20x1,5-AG
G1/8-IG	G1/4-AG	M20x1,5-AG
G1/8-IG	G1/4-AG	M20x1,5-AG
G1/8-IG	G1/4-AG	M20x1,5-AG