



# rtc<sup>®</sup>

COUPLING TECHNOLOGY



# 072

rtc TYPE



**Temperature Range**

-20°C +100°C (-4°F +212°F) Nitril (N)  
-10°C +180°C (+14°F +356°F) FPM (V)

**Max. Working Pressure**

rtc 072.05 400 bar (5800 PSI)  
rtc 072.06 400 bar (5800 PSI)  
rtc 072.10 375 bar (5450 PSI)  
rtc 072.12 350 bar (3625 PSI)  
rtc 072.16 350 bar (5075 PSI)

**Flow size**

rtc 072.05 5 mm  
rtc 072.06 6 mm  
rtc 072.10 10 mm  
rtc 072.12 12 mm  
rtc 072.16 16 mm

**Material**

Socket Body Steel zinc plated  
  
Sleeve Steel zinc plated  
Valve Steel zinc plated  
Springs Stainless steel  
Seal Nitrile (N)  
  
Plug Steel zinc plated

**Using Area**

- On hydraulic oil circuits
- Hydraulic test units
- Injection moulding industries / core pullers



Flow Rate vs Pressure Drop Graph

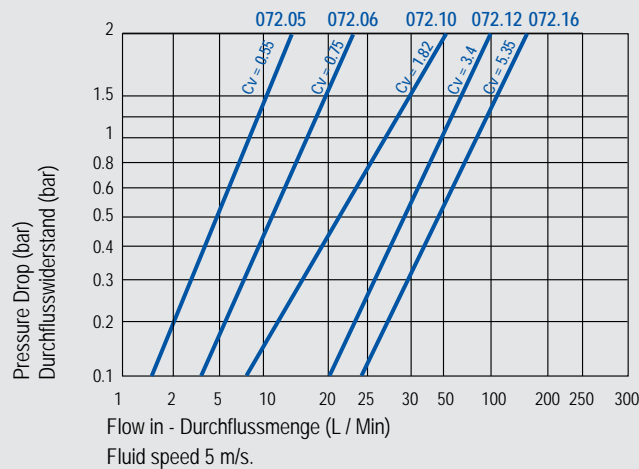

**072**  
rtc TYPE

**rtc** TYPE 072

Female thread socket / Kupplung mit Innengewinde



Socket

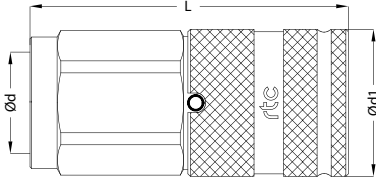

| Size | Order No      | Ød      | Ød1 | L  | HEX. |
|------|---------------|---------|-----|----|------|
| 05   | 072.05 SFB 10 | BSP 1/8 | 20  | 40 | 19   |
| 06   | 072.06 SFB 13 | BSP 1/4 | 28  | 58 | 27   |
| 10   | 072.10 SFB 17 | BSP 3/8 | 32  | 69 | 30   |
| 10   | 072.10 SFB 21 | BSP 1/2 | 32  | 74 | 30   |
| 12   | 072.12 SFB 21 | BSP 1/2 | 38  | 84 | 36   |
| 16   | 072.16 SFB 26 | BSP 3/4 | 42  | 84 | 41   |

**rtc** TYPE 072

Female thread plug / Nippel mit Innengewinde



Plugs

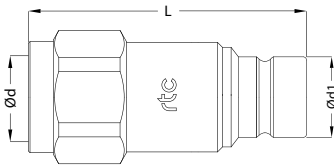

| Size | Order No      | Ød      | Ød1  | L  | HEX. |
|------|---------------|---------|------|----|------|
| 05   | 072.05 PFB 10 | BSP 1/8 | 11.5 | 35 | 17   |
| 06   | 072.06 PFB 13 | BSP 1/4 | 16   | 54 | 22   |
| 10   | 072.10 PFB 17 | BSP 3/8 | 20   | 60 | 27   |
| 10   | 072.10 PFB 21 | BSP 1/2 | 20   | 63 | 27   |
| 12   | 072.12 PFB 21 | BSP 1/2 | 24.5 | 71 | 36   |
| 16   | 072.16 PFB 26 | BSP 3/4 | 27   | 73 | 36   |