



rtc[®]

QUICK CONNECT TECHNOLOGY



103

rtc TYPE





Temperature Range

-20°C +100°C (-5°F +210°F) Nitril (N)
-10°C +180°C (+15°F +356°F) FPM (V)

Max. Working Pressure

rtc 103.08 450 bar (6525 PSI)
rtc 103.11 350 bar (5075 PSI)
rtc 103.12 350 bar (5075 PSI)
rtc 103.15 350 bar (5075 PSI)

Flow size

rtc 103.08 8 mm
rtc 103.11 11 mm
rtc 103.12 12 mm
rtc 103.15 15 mm

Options

- N** NBR Seal
- RED** Red Body
- P** Pressure release valf

Using Area

- On hydraulic oil circuits
- Hydraulic test units
- Injection moulding industries / core pullers

Material

Coupler Body-
Kupplungsgrundkörper AISI 420 / AISI 303 stainless steel

Sleeve Hardened alloysteel

Valve Stainless steel
Springs Stainless steel
Seal FPM (V)
Balls Stainless steel

Plug AISI 420 hardened stainless



Max. Working pressure

Size / Größe	08	11	12	15
Connected	450	450	350	350
Disconnected	180	180	180	180

Max. Residual pressure for connection under pressure (bar)

Coupler / Kupplung	150	150	150	150
Plug / Nippel	50	50	50	50

Flow Rate vs Pressure Drop Graph / Durchflussrate vs Druckabfall

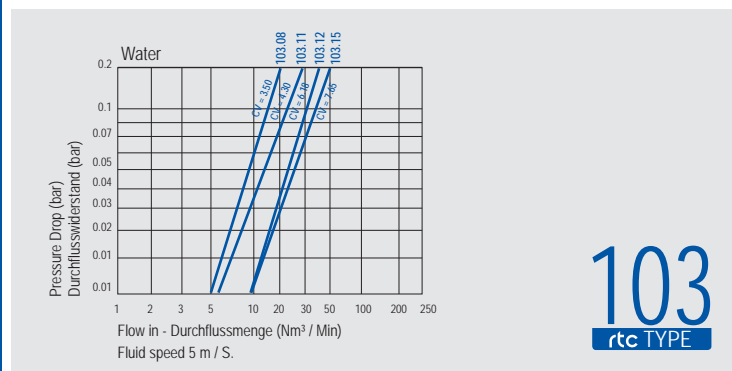

rtc TYPE 103

Female thread socket / Kupplung mit Innengewinde



Socket

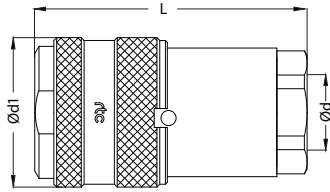

Size	Order No	D	D1	L	HEX.
08	103.08 SFB 21	BSP1/2	40	72	30
11	103.11 SFB 21	BSP1/2	40	72	30
12	103.12 SFB 26	BSP3/4	50	89	41
15	103.15 SFB 26	BSP3/4	50	89	41

rtc TYPE 103

Panel mounted female thread socket / Kupplung mit Innengewinde und Schottverschraubung



Socket

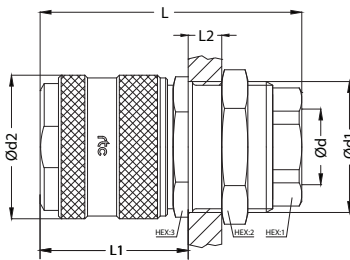

Size	Order No	D	D1	D2	D3	L	L1	L2	HEX.1	HEX.2	HEX.3
08	103.08 SFBP 21	BSP1/2	40	35	13	72	31	13	30	38	36
11	103.11 SFBP 21	BSP1/2	40	35	13	72	31	13	30	38	36
12	103.12 SFBP 26	BSP3/4	50	49	25	89	42	25	41	54	52
15	103.15 SFBP 26	BSP3/4	50	49	25	89	42	25	41	54	52

rtc TYPE 103

Dust cup for socket / Staubkappe für Kupplung

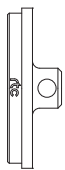

Size	Order No
08	103.08 SD 00
11	103.08 SD 00
12	103.12 SD 00
15	103.12 SD 00



Female thread plug / Nippel mit Innengewinde

TYPE 103 **rtc**

Plugs	Size	Order No	D	D1	L	HEX.
	08	103.08 PFB 21	BSP1/2	32.5	63	30
	11	103.11 PFB 21	BSP1/2	32.5	63	30
	12	103.12 PFB 26	BSP3/4	44.5	74	41
	15	103.15 PFB 26	BSP3/4	44.5	74	41



Panel mounted female thread plug / Nippel mit Innengewinde und Schottverschraubung

TYPE 103 **rtc**

Plugs	Size	Order No	D	D1	D2	L	L1	L2	L3	HEX.1	HEX.2
	08	103.08 PFB 21	BSP1/2	27	36	63	24.5	25.5	38.5	30	32
	11	103.11 PFB 21	BSP1/2	27	36	63	24.5	25.5	38.5	30	32
	12	103.12 PFB 26	BSP3/4	35	41	74	30	25	44	41	38
	15	103.15 PFB 26	BSP3/4	35	41	74	30	25	44	41	38

Dust cup for plug / Staubkappe für Nippel

TYPE 103 **rtc**

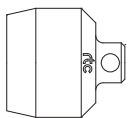

Size	Order No
08	103.08 PD 00
11	103.08 PD 00
12	103.12 PD 00
15	103.12 PD 00