



rtc[®]

COUPLING TECHNOLOGY
www.rtc-tec.com



123

rtc TYPE



Temperature Range - Temperaturbereich

Nitrile (N)	-20°C +100°C (- 4°F +212°F)
FPM (V)	-10°C +180°C (+14°F +356°F)
EPDM (E)	-20°C +150°C (- 40°F +302°F)
FFKM (W)	0°C +300°C (- 40°F +572°F)
FMQ (SN)	-40°C +175°C (- 40°F +347°F)

Max. Working Pressure - Max. Betriebsdruck

rtc 123.03	500 bar (7.250 PSI)
rtc 123.05	300 bar (4.350 PSI)
rtc 123.08	250 bar (3.625 PSI)

Flow size - Nennweiten

rtc 123.03	3 mm
rtc 123.05	5 mm
rtc 123.08	8 mm

Material

Socket Body - Kupplungsgrundkörper	Brass - Messing
Sleeve - Hülse	Stainless Steel - Edelstahl
Valve - Ventil	Brass - Messing
Locking Ring - Sprengring	Stainless Steel - Edelstahl
Balls - Kugeln	Stainless Steel - Edelstahl
Seals - Dichtungen	FKM (V)
Plug - Nippel	Stainless Steel - Edelstahl
Back part Nippel - Nippel Hinterteil	Brass - Messing

Using Area

- On temperature regulation applications with hot or cold water, oil etc.
- On steam line.
- Chemical Industry
- Textile Industry



Flow Rate vs Pressure Drop Graph / Durchflussrate vs Druckabfall

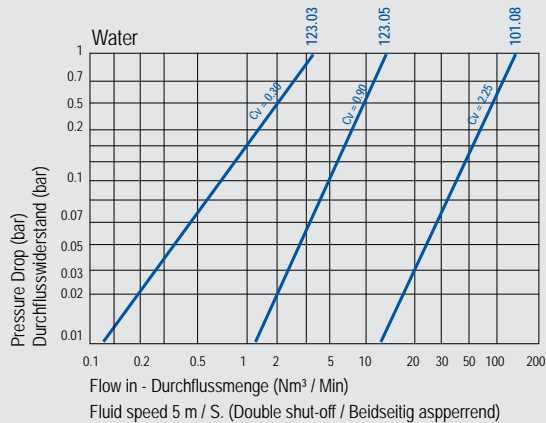

123
rtc TYPE

rtc TYPE 123

Female thread socket / Kupplung mit Innengewinde



Socket / Kupplung

Size
Größe

Order No / Bestellnr.

Ød

Ød1

L

HEX.

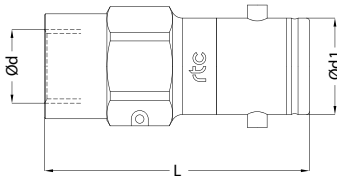

03

123.03 SFB 10

BSP 1/8

13

47

14

123.03 SNB 10

NPT 1/8

13

45

14

123.03 SUB 1024

UNF 3/8-24

13

47

14

05

123.05 SFB 13

BSP 1/4

17

47

19

123.05 SNB 13

NPT 1/4

17

47

19

123.05 SUB 1320

UNF 1/2-20

17

45

19

08

123.08 SFB 17

BSP 3/8

23

50

27

123.08 SNB 17

NPT 3/8

23

50

27

123.08 SUB 1916

UNF 3/4-16

23

51

27

rtc TYPE 123

Male thread socket with 60° sealing cone / Kupplung mit Aussengewinde 60° Dichtkonus



Socket / Kupplung

Size
Größe

Order No / Bestellnr.

Ød

Ød1

L

L1

HEX.

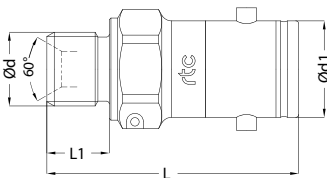

03

123.03 SMB 10

BSP 1/8

13

46

8

14

123.03 STB 10

NPT 1/8

13

48

10

14

05

123.05 SMB 13

BSP 1/4

17

45

11

19

123.05 STB 13

NPT 1/4

17

48

14

19

08

123.08 SMB 17

BSP 3/8

23

50

12

27

123.08 STB 17

NPT 3/8

23

53

15

27

rtc TYPE 123

UNF Male thread socket with 37° sealing cone / Kupplung mit UNF Aussengewinde 37° Dichtkonus



Socket / Kupplung

Size
Größe

Order No / Bestellnr.

Ød

Ød1

L

L1

HEX.

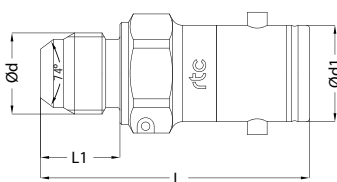

03

123.03 SJB 1024

UNF 3/8-24

13

50

12

14

05

123.05 SJB 1418

UNF 9/16-18

17

48

14

19

08

123.08 SJB 1916

UNF 3/4-16

23

54

16

27

rtc TYPE 123

Socket with Stainless steel tube connection / Kupplung mit Edelstahlrohranschluss



Socket / Kupplung

Size
Größe

Order No / Bestellnr.

Ød

Ød1

L

HEX.

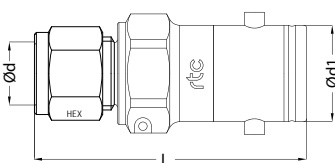

03

123.03 SIB 06

6 mm

13

56

14

123.03 SIB 0635

1/4"

13

55

14

05

123.05 SIB 08

8 mm

17

52

17

123.05 SIB 0950

3/8"

17

54

19

08

123.08 SIB 12

12 mm

23

60

22

123.08 SIB 1270

1/2"

23

59

22



Female thread plug / Nippel mit Innengewinde

TYPE 123 **rtc**

Plugs / Nippel	Size Größe	Order No / Bestellnr.	Ød	Ød1	L	HEX.
	03	123.03 PFB 10	BSP 1/8	17	52	14
		123.03 PNB 10	NPT 1/8	17	50	14
		123.03 PUB 1024	UNF 3/8-24	17	53	14
	05	123.05 PFB 13	BSP 1/4	22	61	19
		123.05 PNB 13	NPT 1/4	22	61	19
		123.05 PUB 1320	UNF 1/2-20	22	61	19
	08	123.08 PFB 17	BSP 3/8	29	68	22
		123.08 PNB 17	NPT 3/8	29	66	22
		123.08 PUB 1916	UNF 3/4-16	29	70	22



Male thread plug with 60° sealing cone / Nippel mit Aussengewinde 60° Dichtkonus

TYPE 123 **rtc**

Plugs / Nippel	Size Größe	Order No / Bestellnr.	Ød	Ød1	L	L1	HEX.
	03	123.03 PMB 10	BSP 1/8	29	43	8	14
		123.03 PTB 10	NPT 1/8	29	45	10	14
	05	123.05 PMB 13	BSP 1/4	35	48	11	19
		123.05 PTB 13	NPT 1/4	35	51	14	19
	08	123.08 PMB 17	BSP 3/8	42	66	12	22
		123.08 PTB 17	NPT 3/8	42	69	15	22



UNF Male thread plug with 37° sealing cone / Nippel mit UNF Aussengewinde 37° Dichtkonus

TYPE 123 **rtc**

Plugs / Nippel	Size Größe	Order No / Bestellnr.	Ød	Ød1	L	L1	HEX.
	03	123.03 PMB 1024	UNF 3/8-24	29	47	12	14
		05	123.05 PMB 1418	UNF 9/16-18	35	51	14
	123.08 PMB 1916		UNF 3/4-16	42	60	16	22



Plug with Stainless steel tube connection / Nippel mit Edelstahlrohranschluss

TYPE 123 **rtc**

Plugs / Nippel	Size Größe	Order No / Bestellnr.	Ød	Ød1	L	HEX.
	03	123.03 SIB 06	6 mm	13	56	14
		123.03 SIB 0635	1/4"	13	55	14
	05	123.05 SIB 08	8 mm	17	52	17
		123.05 SIB 0950	3/8"	17	54	19
	08	123.08 SIB 12	12 mm	23	60	22
		123.08 SIB 1270	1/2"	23	59	22

Dust cup for socket and plug / Staubkappe für Kupplung und Nippel

TYPE 123 **rtc**

Dust cup / Staubkappe	Size Größe	Order No / Bestellnr.
	03	123.03 PD 00
	05	123.05 PD 00
	08	123.08 PD 00

Dust cup / Staubkappe	Size Größe	Order No / Bestellnr.
	03	123.03 SD 00
	05	123.05 SD 00
	08	123.08 SD 00