



# rtc<sup>®</sup>

COUPLING TECHNOLOGY  
[www.rtc-tec.com](http://www.rtc-tec.com)



# 127

rtc TYPE





**Temperature Range**

-20°C +100°C (-4°F +212°F ) Nitril (N)  
 -10°C +180°C (+14°F +356°F ) FPM (V)  
 -20°C +150°C (-4°F +302°F ) EPDM (E)

**Max. Working Pressure**

rtc 127.37 10 bar (145 PSI)

**Flow size**

rtc 127.37 37 mm

**Standard version**

Nitrile (NBR)

**Options**

Fluorocarbone - FPM (V)  
 EPDM: (E)

**Material**

Coupler Body - Kupplungsgrundkörper	Brass Nickel Plated - Messing Vernickelt
Sleeve - Hülse	Brass Nickel Plated - Messing Vernickelt
Valve - Ventil	Brass Nickel Plated - Messing Vernickelt
Springs - Federn	Stainless Steel - Edelstahl
Seals - Dichtungen	Nitrile (N)
Plug - Nippel	Brass Nickel Plated - Messing vernickelt



Flow Rate vs Pressure Drop Graph / Durchflussrate vs Druckabfall

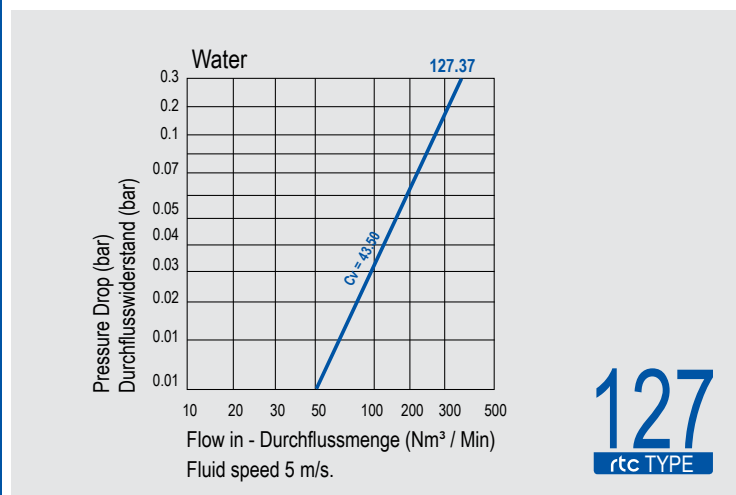

**127**  
rtc TYPE

**rtc** TYPE 127

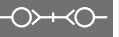

Socket / Kupplung

Size Größe	Connection (Ød)	Order No / Bestellnr.	Ød1 (mm)	L (mm)	HEX.
37	BSP 2	127.37 SFB 60	39	138	77
37	NPT 2	127.37 SNB 60	39	138	77
37	UNF 2-1/2-12	127.37 SUB 63	39	138	77

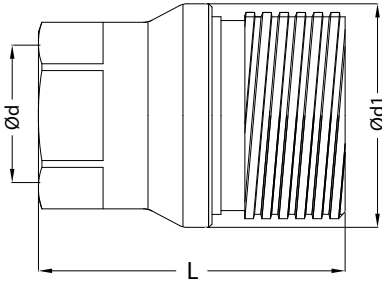

**rtc** TYPE 127

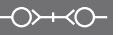

Plug / Nippel

Size Größe	Connection (Ød)	Order No / Bestellnr.	Ød1 (mm)	L (mm)	HEX.
37	BSP 2	127.37 PFB 60	39	138	77
37	NPT 2	127.37 PNB 60	39	138	77
37	UNF 2-1/2-12	127.37 PUB 63	39	138	77

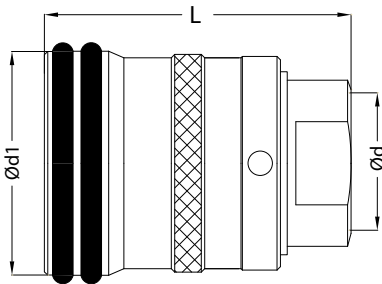

**rtc** TYPE 127

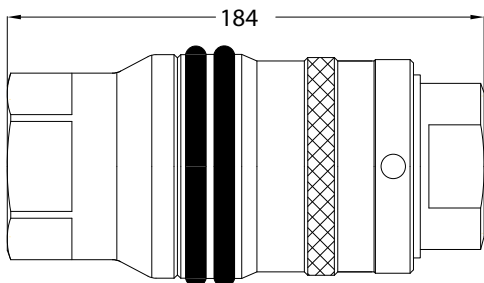

Size Größe	Brass Messing	Steel Stahl	Stainless Steel / Edelstahl (AISI 303 / AISI 316)
BSP 2	30 bar	95 bar	90 bar