

Interface for QC quick changer

(kit with screws)

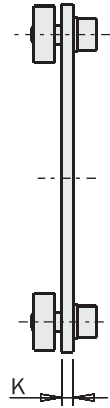

	MFI-A102	MFI-A103
A [mm]	Ø37	Ø70
B [mm]	35	74
C [mm]	76	130
E [mm]	35	52
F [mm]	76	110
G [mm]	16	24
H [mm]	8	12
I [mm]	6	15
J [mm]	43.5	72.5
K [mm]	3	4
N [mm]	Ø5.2	Ø6.2
QC...-B	QC90-B	QC150-B QC160-B
Peso / Weight	190 g	540 g

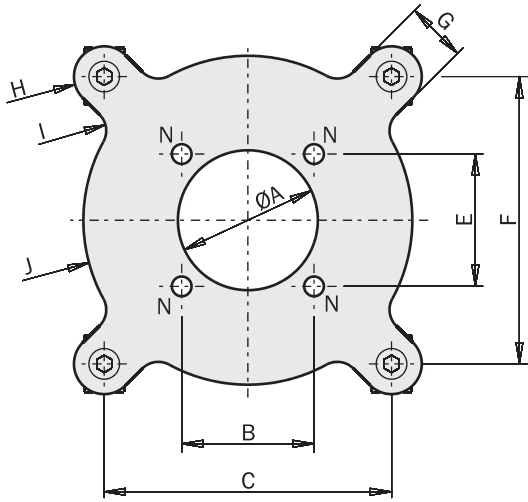

Application example

