



rtc[®]

COUPLING TECHNOLOGY
www.rtc-tec.com



017

rtc TYPE



DN 5 & 9.5 mm Pneumatic Coupling

TYPE 017



Compatible

Rectus 17KA
Schrader NW5

Temperature Range

Nitrile (N) -20°C + 100°C (- 4°F + 212°F)
FPM (V) -20°C + 180°C (- 4°F + 356°F)
EPDM (Ethylene Propylene) -40°C + 150°C (- 40°F + 302°F)

Working Pressure

35 Bar (510 PSI)

Flow size

rtc type 017.05 5 mm
rtc type 017.10 9.5 mm

Standard version

Seals - Dichtung : Nitrile (N)

Material of Standard Coupler

Socket body	Steel nickel plated -
Kupplungsgrundkörper	Stahl Nickel beschichtet
Sleeve	Steel nickel plated -
Hülse	Stahl Nickel beschichtet
Valve - Ventil	Brass - Messing
Springs - Federn	Stainless Steel - Edelstahl
Balls - Kugeln	Stainless Steel - Edelstahl
Seals - Dichtung	Nitrile (N)
Plug -	Steel zinc-nickel plated -
Nippel	Stahl Zink-Nickel beschichtet

Technical Specifications & Advantages

- English Industrial Profile
- Advantage of one hand useage.
- Compact dimensions.
- High flow valve.



Flow Rate vs Pressure Drop Graph

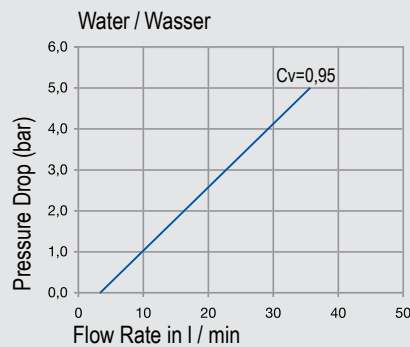
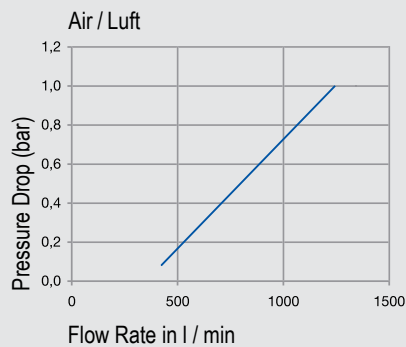

017
rtc TYPE

rtc TYPE 017

Male thread socket / Kupplung mit Aussengewinde



Sockets / Kupplungen

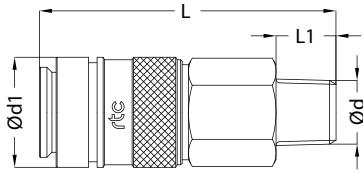

Size / Größe	Order No / Bestellnr. With Valve / Mit Ventil	Order No / Bestellnr. Without Valve / Ohne Ventil	Ød	Ød1	L	L1	HEX.
5	017.05 SRO 10	017.05 SRF 10	BSPT 1/8	22	56	9	19
5	017.05 SRO 13	017.05 SRF 13	BSPT 1/4	22	59	12	19
5	017.05 SRO 17	017.05 SRF 17	BSPT 3/8	22	58	12	19
5	017.05 SRO 21	017.05 SRF 21	BSPT 1/2	22	58	17	22
9.5	017.10 SRO 17	017.10 SRF 17	BSPT 3/8	30	68	12	27
9.5	017.10 SRO 21	017.10 SRF 21	BSPT 1/2	30	73	17	27
9.5	017.10 SRO 26	017.10 SRF 26	BSPT 3/4	30	65	17	27

rtc TYPE 017

Female thread socket / Kupplung mit Innengewinde



Sockets / Kupplungen

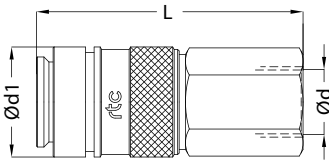

Size / Größe	Order No / Bestellnr. With Valve / Mit Ventil	Order No / Bestellnr. Without Valve / Ohne Ventil	Ød	Ød1	L	HEX.
5	017.05 SFO 10	017.05 SFF 10	BSP 1/8	22	54	19
5	017.05 SFO 13	017.05 SFF 13	BSP 1/4	22	54	19
5	017.05 SFO 17	017.05 SFF 17	BSP 3/8	22	53	19
5	017.05 SFO 21	017.05 SFF 21	BSP 1/2	22	56	24
9.5	017.10 SFO 13	017.10 SFF 13	BSP 1/4	30	71	27
9.5	017.10 SFO 17	017.10 SFF 17	BSP 3/8	30	71	27
9.5	017.10 SFO 21	017.10 SFF 21	BSP 1/2	30	71	27

rtc TYPE 017

Standard hose tail socket / Kupplung mit gerader Standard - Schlauchtülle



Sockets / Kupplungen

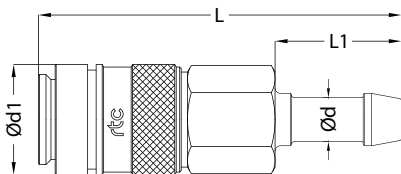

Size / Größe	Order No / Bestellnr. With Valve / Mit Ventil	Order No / Bestellnr. Without Valve / Ohne Ventil	Ød	Ød1	L	L1
5	017.05 SHO 06	017.05 SHF 06	6 mm	22	70	23
5	017.05 SHO 08	017.05 SHF 08	8 mm	22	70	23
5	017.05 SHO 09	017.05 SHF 09	9 mm	22	70	23
5	017.05 SHO 10	017.05 SHF 10	10 mm	22	70	23
5	017.05 SHO 13	017.05 SHF 13	13 mm	22	70	23
9.5	017.10 SHO 10	017.10 SHF 10	10 mm	30	79	23
9.5	017.10 SHO 13	017.10 SHF 13	13 mm	30	79	23
9.5	017.10 SHO 16	017.10 SHF 16	16 mm	30	82	26
9.5	017.10 SHO 19	017.10 SHF 19	19 mm	30	89	33



Male thread plug / Nippel mit Aussengewinde

TYPE 017 **rtc**

Plugs / Nippel	Size / Größe	Order No / Bestellnr. Without Valve / Ohne Ventil	Ød	Ød1	L	L1	HEX.
	5	017.05 PRF 10	BSPT 1/8	11	37	9	14
	5	017.05 PRF 13	BSPT 1/4	11	41.5	12	14
	5	017.05 PRF 17	BSPT 3/8	11	41.5	12	17
	5	017.05 PRF 21	BSPT 1/2	11	46.5	17	22
	9.5	017.10 PRF 13	BSPT 1/4	17	49	12	19
	9.5	017.10 PRF 17	BSPT 3/8	17	49	12	19
	9.5	017.10 PRF 21	BSPT 1/2	17	53	17	22



Female thread plug / Nippel mit Innengewinde

TYPE 017 **rtc**

Plugs / Nippel	Size / Größe	Order No / Bestellnr. Without Valve / Ohne Ventil	Ød	Ød1	L	HEX.
	5	017.05 PFF 10	BSP 1/8	11	48	13
	5	017.05 PFF 13	BSP 1/4	11	40	17
	5	017.05 PFF 17	BSP 3/8	11	40	19
	9.5	017.10 PFF 13	BSP 1/4	17	46	19
	9.5	017.10 PFF 17	BSP 3/8	17	47	19
	9.5	017.10 PFF 21	BSP 1/2	17	50	24



Standard hose tail plug / Nippel mit gerader Standard - Schlauchtülle

TYPE 017 **rtc**

Plugs / Nippel	Size / Größe	Order No / Bestellnr. Without Valve / Ohne Ventil	Ød	Ød1	L	L1
	5	017.05 PHF 06	6 mm	11	51	23
	5	017.05 PHF 08	8 mm	11	51	23
	5	017.05 PHF 10	10 mm	11	51	23
	5	017.05 PHF 13	13 mm	11	51	23
	9.5	017.10 PHF 08	8 mm	17	55	23
	9.5	017.10 PHF 10	10 mm	17	55	23
	9.5	017.10 PHF 13	13 mm	17	55	23
	9.5	017.10 PHF 16	16 mm	17	55	23