



# rtc<sup>®</sup>

QUICK CONNECT TECHNOLOGY



# 098

rtc TYPE



Temperature Range

FPM (V) -20°C + 180°C (- 4°F + 356°F)

Working Pressure -

rtc 098.06 16 bar (290 PSI)  
 rtc 098.08 20 bar (290 PSI)  
 rtc 098.12 20 bar (290 PSI)

Working Pressure  
Stainless Steel

rtc 098.08 100 bar (1450 PSI)  
 rtc 098.12 100 bar (1450 PSI)

Flow size

rtc 098.06 6 mm  
 rtc 098.08 8 mm  
 rtc 098.12 12 mm

Material of Standard Coupler

Socket body	Brass
Valve	Brass
Springs	Stainless Steel
Plug body	Brass Nickel plated
Plug back part	Brass
Nippel hinterteil	Messing

Material of rtc 098.06

- Aluminium socket and plug body

Using Area

- On temperature regulation applications of mold and tool changer with hot or cold water, oil etc
- Injection moulding industries
- On steam line

Material of Stainless Steel Coupler

Socket body	Stainless Steel
Sleeve	Stainless Steel
Springs	Stainless Steel
Locking Ring	Stainless Steel
Balls	Stainless Steel
Plug	Stainless Steel



Flow Rate vs Pressure Drop Graph / Durchflussrate vs Druckabfall

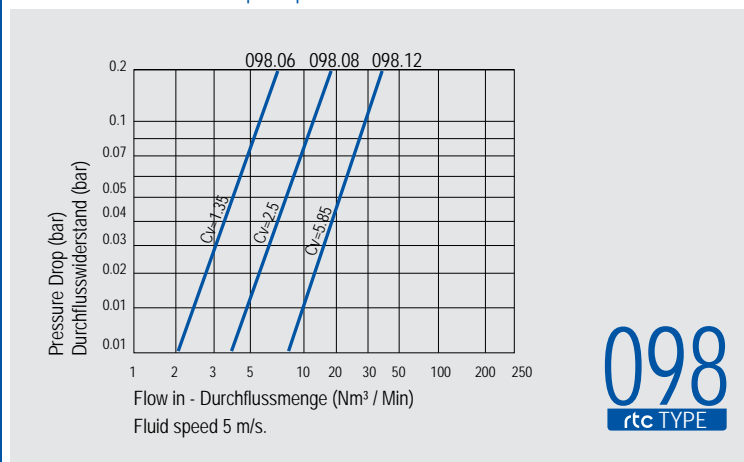

098  
rtc TYPE

**rtc** TYPE 098.06

Male thread socket with valve / Verschlusskupplung mit Aussengewinde



Socket / Kupplung

Size / Grosse	Order No / Bestellnr.	Ød	Ød1	L	L1	HEX.
6.0	098.06 SMB 1810	M18x1.0	22	18.2	7.2	20
6.0	098.06 SMB 1810-DH	M18x1.0	22	18.2	7.2	20

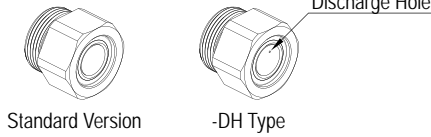
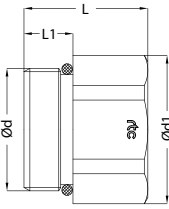

**rtc** TYPE 098.06

Male thread plug with valve / Verschlussnippel mit Aussengewinde



Plugs / Nippel

Size / Grosse	Order No / Bestellnr.	Ød	Ød1	L	L1	L2	L3	HEX.
6.0	098.06 PMB 1810	M18x1.0	22	31.8	10.5	5.9	20.5	20

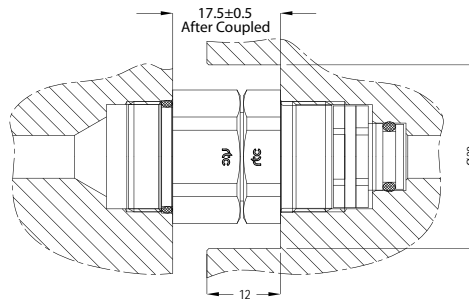
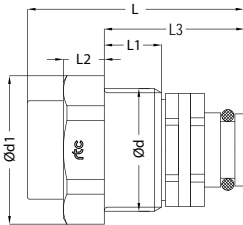

**rtc** TYPE 098

Male thread socket with valve / Verschlusskupplung mit Aussengewinde



Socket / Kupplung

Size / Grosse	Order No / Bestellnr.	Ød	Ød1	Ød2	L	L1	HEX.
8.0	098.08 SMB 2415	M24x1.5	27	29.5	22	6.5	27
12.0	098.12 SMB 3315	M33x1.5	38	42	22	6.5	38

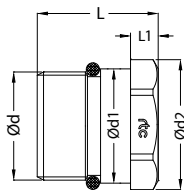

**rtc** TYPE 098

Female thread socket with valve / Verschlusskupplung mit Innengewinde



Socket / Kupplung

Size / Grosse	Order No / Bestellnr.	Ød	Ød1	Ød2	L	L1	HEX.
8.0	098.08 SFB 17	BSP 3/8	27	29.5	40.5	6.5	27
12.0	098.12 SFB 26	BSP 3/4	38	42	48	6.5	38

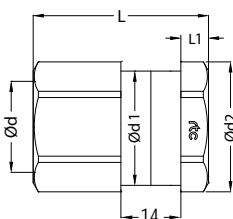



Male thread plug with valve / Verschlussnippel mit Aussengewinde

TYPE 098



Plugs / Nippel

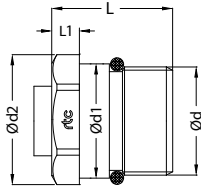

Size / Grösse	Order No / Bestellnr.	Ød	Ød1	Ød2	L	L1	HEX.
8.0	098.08 PMB 2415	M24x1.5	27	29.5	22	6.5	27
12.0	098.12 PMB 3315	M33x1.5	38	42	22	6.5	38



Female thread plug with valve / Verschlussnippel mit Innengewinde

TYPE 098



Plugs / Nippel

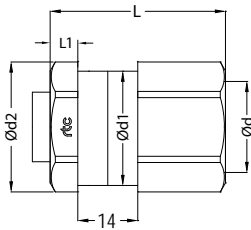

Size / Grösse	Order No / Bestellnr.	Ød	Ød1	Ød2	L	L1	HEX.
8.0	098.08 PFB 17	BSP 3/8	27	29.5	46	6.5	27
12.0	098.12 PFB 26	BSP 3/4	38	42	48	6.5	38



90° Female thread socket with valve / 90° Verschlusskupplung mit Innengewinde

TYPE 098



Socket / Kupplung

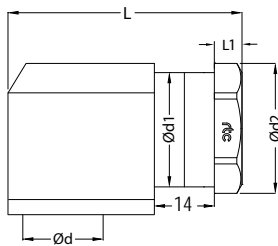

Size / Grösse	Order No / Bestellnr.	Ød	Ød1	Ød2	L	L1	HEX.
8.0	098.08 SFB 17-90	BSP 3/8	27	29.5	63	6.5	27
12.0	098.12 SFB 21-90	BSP 1/2	38	42	63	6.5	38
12.0	098.12 SFB 26-90	BSP 3/4	38	42	68	6.5	38



90° Female thread plug with valve / 90° Verschlussnippel mit Innengewinde

TYPE 098



Plugs / Nippel

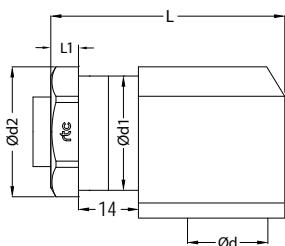

Size / Grösse	Order No / Bestellnr.	Ød	Ød1	Ød2	L	L1	HEX.
8.0	098.08 PFB 17-90	BSP 3/8	27	29.5	63	6.5	27
12.0	098.12 PFB 21-90	BSP 1/2	38	42	63	6.5	38
12.0	098.12 PFB 26-90	BSP 3/4	38	42	68	6.5	38

